

PATIO ROOF COVER SUBMITTAL REQUIREMENTS

- ☐ Attach a copy of the City Permit to the application if structure is over 120 square feet or any structure that has gas, water, or electric. This must be turned in with the application.
- ☐ Elevation plans
- ☐ Sample photos of proposed patio roof cover
- ☐ Photograph of the existing house showing where the proposed covered patio will be located.

Dimensions of the patio cover:

Height: _____

Width: _____

Length: _____

Depth: _____

Square footage: _____

- ☐ Attach Construction plans, drawn to scale, which adequately describe the scope of project.
- ☐ Roof plans- Roof pitch, Rise over Run (Span) dimensions (see example below, your contractor must draw up something like this for your roof plan)

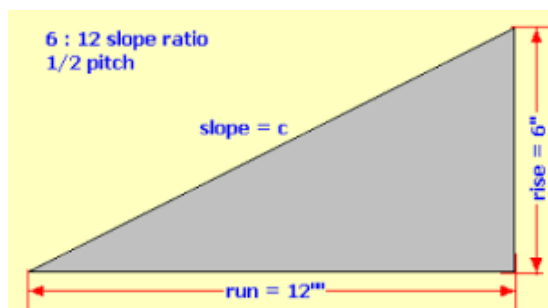
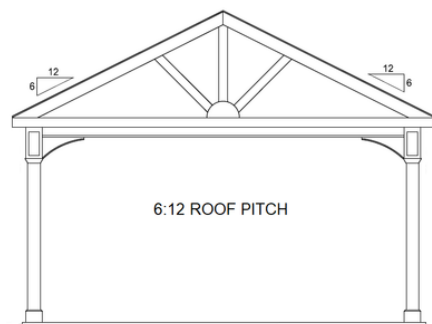

Building materials including:

Type of masonry: _____ (name & color of approved materials that match the home i.e., Stone, Hardie, or Brick)

☐ Attach sample photos of masonry

Type of wood: _____ (Cedar or Redwood are approved material)

Stain manufacturer: _____

Stain color name: _____

Stain color number: _____

☐ Attach Stain photo samples

Roofing materials:

Shingles Manufacturer: _____

Shingles Color: _____

Shingles Warranty: _____

☐ Attach a shingle spec sheet and front elevation photo of the home to show the roof will match the home.

Is this property on a Zero Lot Line (Yes or no) _____

Village Name: _____

Phase, if applicable: _____

Type of lot (i.e., golf course, corner lot, on common area): _____

Is this MOD App in response to a violation? (Yes or no): _____

If yes, what is the statement in the violation letter the owner received: _____

Any other pertinent details:

Please review both the **SRCA Modification Design Guidelines** and the **Village Guidelines** for your specific subdivision on our website at www.stonebridgeranch.com. In all cases, you need to follow the most restrictive guideline, whether it is located in the SRCA Modification Design Guidelines or your village's guidelines. A number of villages in Stonebridge Ranch are part of the SRCA as well as members of a neighborhood sub-association. If your home is located in one of these villages, you may need to submit and receive modification approval from your sub-association after receiving project approval from the SRCA. If you have further questions, please contact the Association office.

After approval, project will be subject to a compliance inspection upon completion. It is the homeowner's responsibility to notify the office once project is complete.

I certify that I have reviewed the application and have made sure that everything on the submittal requirements form is submitted with the application and have read the Modification Design Guidelines and Village Guidelines for this project:

Property Owners Signature: _____ Date: _____